

COMBI 740 is an electro-hydraulic operator consisting of a drive unit - motor/pump - and a hydraulic jack.

For safety reasons, anti-crush, the unit motor-pump-jack is fitted with pressure valves incorporated in the hydraulic circuit and adequately protected to prevent misuse after the operator has been installed on the gate.

Designed so that it is unaffected by rain, water, dust or any other atmospheric agent.

COMBI 740 is to be sunk into the ground at the foot of the gates on the right-hand and left-hand side (double swinging gates) to achieve synchronized operations.

Different options are available, ie. 110° or 175° rotation angle with no variation in size, with or without dampening device on both open and close cycles. With or without two-way locking device. A locking unit can be released for hand operations by means of the lever placed above the pressure valves. The units are supplied perfectly working and already filled with special oil.

No pre-adjustment is needed, the operator is ready to work after completing the installation.

The gate can be fixed onto the COMBI 740 operator in three different ways: by the emergency release bracket (for hydraulic jacks with hydraulic locking device), the support plate with square-bored ferrule (for hydraulic jacks without hydraulic locking device) and the square-bored ferrule (for hydraulic jacks without hydraulic locking device).

In all the cases, these elements are to be firmly welded to the base of the gate and aligned with the gate upper pivot.

Tested and certified **CE** marking and type testing according to ITT PDC No. 2393-2008.

TECHNICAL SPECIFICATIONS

TWO-PHASE CLASS H ELECTRIC MOTOR

| | |
|----------------------|-------------------|
| Power output | 0,18 kW (0,25 HP) |
| Absorbed power | 250 W |
| Frequency | 50 Hz |
| Supply voltage | 230 Vac |
| Absorbed current | 1,2 A |
| Capacitor | 12,5 µF |
| Motor rotation speed | 1.350 rpm |
| Intermittent service | S3 |

PERFORMANCE (110° shaft rotation angle)

| | |
|---|-----------------|
| Frequency of use | very intensive |
| Service cycle | opening ~ 23 s |
| | dwelling ~ 30 s |
| | closing ~ 23 s |
| | dwelling ~ 30 s |
| Complete cycle time | ~ 106 s |
| Complete cycles | |
| opening-dwelling-closing-dwelling | No. 34/hour |
| Annual cycles (with 8 hours of use per day) | No. 99.280 |

DOUBLE STROKE JACK AND OIL-HYDRAULIC PUMP

| | |
|--------------------------------------|------------------------|
| P3 - Hydraulic pump capacity | 0,85 l/min |
| Working temperature | -20°C +80°C (*) |
| Oil type | Oil Fadini - Item 708L |
| Shaft rotation | 110° - 175° |
| Working torque | 250 - 400 Nm |
| Piston diameter | 75 mm |
| Piston stroke | 52 mm |
| Weight with enclosure | 27 kg |
| Protection standard | IP 67 |
| Max. gate weight per leaf | 700 kg |
| Max. gate width per leaf | 4 m |
| Dimensions (length x width x height) | 470x300x140 mm |

PERFORMANCE (175° shaft rotation angle)

| | |
|---|-----------------|
| Frequency of use | very intensive |
| Service cycle | opening ~ 28 s |
| | dwelling ~ 30 s |
| | closing ~ 28 s |
| | dwelling ~ 30 s |
| Complete cycle time | ~ 116 s |
| Complete cycles | |
| opening-dwelling-closing-dwelling | No. 31/hour |
| Annual cycles (with 8 hours of use per day) | No. 90.520 |

NOTE: It is always recommended to install an electric lock with gate leaves wider than 2,0 m.

(*) -40 °C with specific optional accessories (Ref. General Catalogue).

VERSIONS

- Braking in opening and closing
- Non braking
- Hydraulic device for bidirectional locking
- Non locking (reversible): an electric lock is needed
- With flow regulator

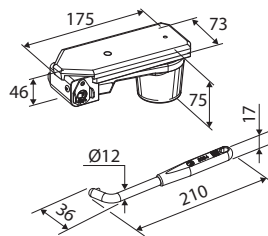
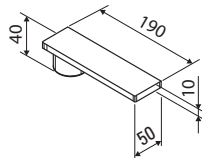
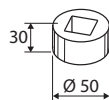
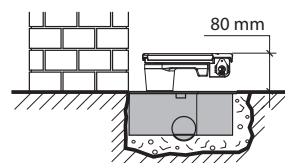
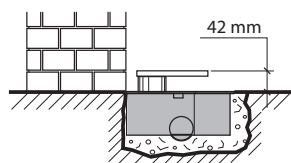
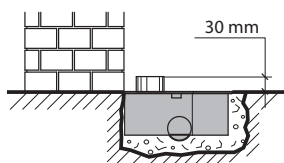

Square-bored ferrule

Squared-bored ferrule with support plate

Emergency release bracket with square-bored ferrule, spanner and plate to weld



FADINI
the gate opener
Made in Italy

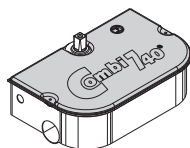

Drwg. No. **1598**

TECHNICAL DATA TABLE

05/15

OIL-HYDRAULIC UNDERGROUND OPERATOR FOR SWINGING GATES

COMBI 740

